

Plant Health Insect Quarantine Facilities at Central Science Laboratory, York

The Central Science Laboratory (CSL) York, carries out a wide range of work on non-indigenous plant pests and diseases many of these are subject to statutory controls under both UK and European Legislation and must be held in Licensed Quarantine Facilities.



The move to York allowed CSL to build a state of the art facility for working on such organisms.

The plant pest section operates under strict conditions as it holds insect and other organisms that actively move. These are secure and only accessible to authorised personnel

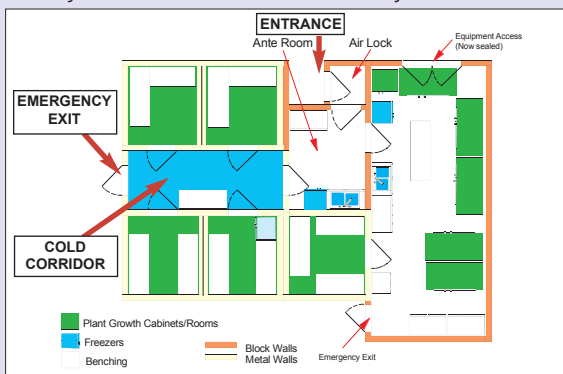

The whole area is a sealed unit entered through a double door system, all internal doors are fitted with alarms to prevent any two adjacent doors being opened at the same time

The growth rooms open onto a cold corridor (-15°C), so should any insects escape they will be immobilised and killed



The facility consists of 5 plant growth rooms and 5 plant growth cabinets of various sizes.



The rooms can all work at either negative or positive pressure dependent on the nature of the exclusion/containment required. All air exchange is through fine filters to prevent organisms being carried out (or in).



Special clothing which is frozen after use and standard operating procedures for handling insects all help to minimise the risk of escape.



Specially designed Perspex cages keep the insects contained even when changing food plants.



Thrip proof cages are constructed from electrical switchgear boxes.



Authors

Richard Natt
r.natt@csl.gov.uk

Address

Central Science Laboratory,
Sand Hutton,
York,
YO41 1LZ.
UK.

Acknowledgement

I thank the UK CEUG for the award of a travel bursary and acknowledge Defra for funding this work.



CSL is an Executive Agency of Defra

